

Extra thin metric series: 6700,6800,6900

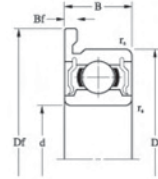
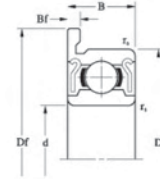
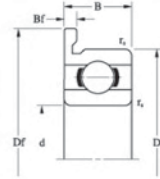
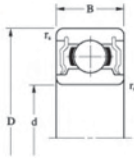
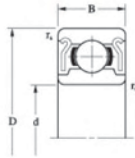
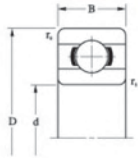

Technical

Dimension

Bore Diameter: d		Outer Diameter: D		Flange Diameter: Df		Radius r _s (min)		Width: B		Flange Width: Bf		Bearing Reference			
mm	inch	mm	inch	mm	inch	mm	inch	mm	inch	mm	inch	Open	Flange Open	Shield	Flange Shield
10	0.3937	15	0.5906	16.5	0.6496	0.15	0.0059	3	0.1181	0.8	0.0315	6700	F6700	—	—
		15	0.5906	16.5	0.6496	0.15	0.0059	4	0.1575	0.8	0.0315	—	—	6700ZZS	F6700ZZS
		19	0.7480	21.0	0.8268	0.30	0.0118	5	0.1969	1.0	0.0394	6800	F6800	6800ZZ	F6800ZZ
		19	0.7480	21.0	0.8268	0.30	0.0118	7	0.2756	1.5	0.0591	63800	F63800	63800ZZ	F63800ZZ
		22	0.8661	25.0	0.9843	0.30	0.1181	6	0.2362	1.5	0.0591	6900	F6900	6900ZZ	F6900ZZ
12	0.4724	18	0.7087	19.5	0.7677	0.20	0.0079	4	0.1575	0.8	0.0315	6701	F6701	6701ZZS	F6701ZZS
		21	0.8268	23.0	0.9055	0.30	0.0118	5	0.1969	1.1	0.0433	6801	F6801	6801ZZ	F6801ZZ
		21	0.8268	23.0	0.9055	0.30	0.0118	7	0.2756	1.5	0.0591	63801	F63801	63801ZZ	F63801ZZ
		24	0.9449	26.5	1.0433	0.30	0.0118	6	0.2362	1.5	0.0591	6901	F6901	6901ZZ	F6901ZZ
15	0.5906	21	0.8268	22.5	0.8858	0.20	0.0079	4	0.1575	0.8	0.0315	6702	F6702	6702ZZS	F6702ZZS
		24	0.9449	26.0	1.0236	0.30	0.0118	5	0.1969	1.1	0.0433	6802	F6802	6802ZZ	F6802ZZ
		24	0.9449	26.0	1.0236	0.30	0.0118	7	0.2756	1.5	0.0591	63802	F63802	63802ZZ	F63802ZZ
		28	1.1024	30.5	1.2008	0.30	0.0118	7	0.2756	1.5	0.0591	6902	F6902	6902ZZ	F6902ZZ
17	0.6693	23	0.9055	24.5	0.9646	0.20	0.0079	4	0.1575	0.8	0.0315	6703	F6703	6703ZZS	F6703ZZS
		26	1.0236	28.0	1.1024	0.30	0.0118	5	0.1969	1.1	0.0433	6803	F6803	6803ZZ	F6803ZZ
		26	1.0236	28.0	1.1024	0.30	0.0118	7	0.2756	1.5	0.0591	63803	F63803	63803ZZ	F63803ZZ
		30	1.1811	32.5	1.2795	0.30	0.0118	7	0.2756	1.5	0.0591	6903	F6903	6903ZZ	F6903ZZ
20	0.7874	27	1.0630	28.5	1.1220	0.20	0.0079	4	0.1575	0.8	0.0315	6704	F6704	6704ZZS	F6704ZZS
		32	1.2598	35.0	1.3780	0.30	0.0118	7	0.2756	1.5	0.0591	6804	F6804	6804ZZ	F6804ZZ
		32	1.2598	35.0	1.3780	0.30	0.0118	10	0.3937	2.0	0.0787	63804	F63804	63804ZZ	F63804ZZ
		37	1.4567	40.0	1.5748	0.30	0.0118	9	0.3543	2.0	0.0787	6904	F6904	6904ZZ	F6904ZZ
25	0.9843	32	1.2598	34.0	1.3386	0.20	0.0079	4	0.1575	1.0	0.0394	6705	F6705	—	—
		37	1.4567	40.0	1.5748	0.30	0.0118	7	0.2756	1.5	0.0591	6805	F6805	6805ZZ	F6805ZZ
		37	1.4567	40.0	1.5748	0.30	0.0118	10	0.3937	2.0	0.0787	63805	F63805	63805ZZ	F63805ZZ
		42	1.6535	45.0	1.7717	0.30	0.0118	9	0.3543	2.0	0.0787	6905	F6905	6905ZZ	F6905ZZ
30	1.1811	37	1.4567	39.0	1.5354	0.20	0.0079	4	0.1575	1.0	0.0394	6706	F6706	—	—
		42	1.6535	45.0	1.7717	0.30	0.0118	7	0.2756	1.5	0.0591	6806	F6806	6806ZZ	F6806ZZ
		42	1.6535	45.0	1.7717	0.30	0.0118	10	0.3937	2.0	0.0787	63806	F63806	63806ZZ	F63806ZZ
		47	1.8504	50.0	1.9685	0.30	0.0118	9	0.3543	2.0	0.0787	6906	F6906	6906ZZ	F6906ZZ

1) Bearings also available with single shield or seal : suffix Z, RS, RU or TS
 2) Bearings also available with stainless material : suffix H
 3) SUJ2 bearings use RU type retainer, stainless bearings use J type retainer.

Seal			Load Rating		Max. Speed		Cage Type	Ball Complement			Weight (Ref.)	
2RS	2RU	TTS	Cr(N)	Cor(N)	Grease	Oil		Qty.:Z	Size:Dw	Shield	Flange Shield	
					x1000rpm					g		
—	—	—	855	435	15	17	W	11	1.588	0.0625	1.4	1.6
2RS	—	TTS	855	435	15	17	W	11	1.588	0.0625	1.9	2.1
2RS	2RU	—	1716	840	37	43	J,TW	10	2.381	0.0937	5.6	6.1
2RS	2RU	—	1716	840	37	43	J,TW	10	2.381	0.0937	7.4	8.1
2RS	2RU	—	2695	1273	34	41	J	9	3.175	0.1250	10.0	11.3
2RS	—	TTS	926	530	13	15	W	13	1.588	0.0625	3.1	3.4
2RS	2RU	—	1915	1041	33	39	J,TW	12	2.381	0.0937	6.5	7.1
2RS	2RU	—	1915	1041	33	39	J,TW	12	2.381	0.0937	8.5	9.3
2RS	2RU	—	2886	1466	31	36	J	10	3.175	0.1250	12.0	13.2
2RS	—	TTS	937	582	11	13	W	14	1.588	0.0625	3.6	3.9
2RS	2RU	—	2073	1253	28	33	J,TW	14	2.381	0.0937	7.6	8.3
2RS	2RU	—	2073	1253	28	33	J,TW	14	2.381	0.0937	10.0	10.9
2RS	2RU	—	4321	2259	26	30	J	10	3.969	0.1563	19.0	19.9
2RS	—	TTS	1000	658	9.5	11	W	16	1.588	0.0625	4.0	4.4
2RS	2RU	—	2233	1456	26	30	J,TW	16	2.381	0.0937	8.2	8.9
2RS	2RU	—	2233	1456	26	30	J,TW	16	2.381	0.0937	11.0	12.0
2RS	2RU	—	4588	2565	23	38	J	11	3.969	0.1563	20.0	21.4
2RS	—	TTS	1402	729	8.5	10	W	18	1.588	0.0625	5.9	6.3
2RS	2RU	—	4015	2462	21	25	J,RJ ³⁾	13	3.500	0.1378	18.0	19.8
2RS	2RU	—	4015	2462	21	25	J,RJ ³⁾	13	3.500	0.1378	24.0	26.5
2RS	2RU	—	6381	3682	19	23	RJ	11	4.782	0.1875	40.0	42.8
2RS	—	—	1091	838	7	8	W	21	1.588	0.0625	7.1	7.9
2RS	2RU	—	4303	2932	18	21	J,RJ ³⁾	15	3.500	0.1378	24.0	26.1
2RS	2RU	—	4303	2932	18	21	J,RJ ³⁾	15	3.500	0.1378	32.0	34.1
2RS	2RU	—	7001	4540	16	19	RJ	13	4.782	0.1875	47.0	50.2
—	2RU	—	1143	947	5.5	7	W	24	1.588	0.0625	8.3	9.2
2RS	2RU	—	4538	3402	15	18	J,RJ ³⁾	17	3.500	0.1378	27.0	29.4
2RS	2RU	—	4538	3402	15	18	J,RJ ³⁾	17	3.500	0.1378	36.0	39.2
2RS	2RU	—	7242	5003	14	17	RJ	14	4.782	0.1875	53.0	56.6