

Inch series

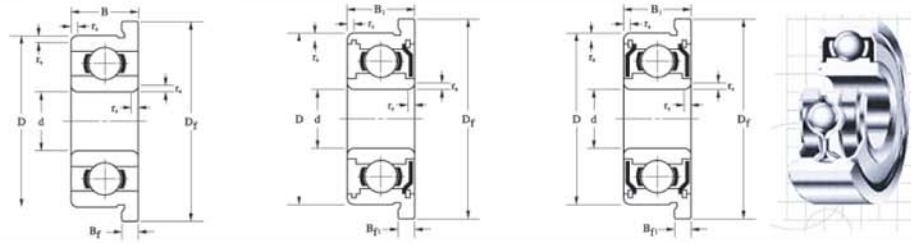

Inch series

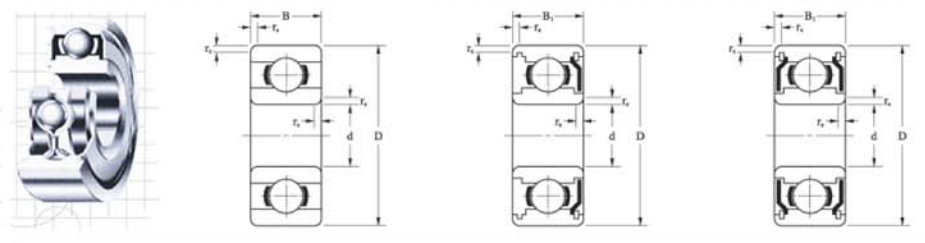

Width: B1		Flange Width: Bf1		Load Rating		Max. Speed		Cage Type	Ball Complement			Weight (Reference)			
inch	mm	inch	mm	Cr(N)	Cor(N)	Grease	Oil		Qty. Z	Size: Dw		Open	Flange Open	Shield	Flange Shield
										inch	mm				
—	—	—	—	106	28	130	150	W	6	0.0250	0.635	0.05	0.07	—	—
0.0937	2.380	0.0310	0.787	112	33	110	130	W	7	0.0236	0.600	0.10	0.12	0.15	0.20
0.1094	2.779	0.0310	0.787	232	67	90	110	W	6	0.0394	1.000	0.15	0.19	0.19	0.25
0.1406	3.571	0.0310	0.787	284	96	67	80	W	7	0.0394	1.000	0.40	0.46	0.53	0.61
—	—	—	—	189	60	80	95	W	7	0.0315	0.800	0.10	0.13	—	—
0.0937	2.380	0.0310	0.787	144	53	80	95	W	10	0.0236	0.600	—	—	0.15	0.21
0.1406	3.571	0.0310	0.787	552	176	60	71	W	6	0.0625	1.588	0.80	0.67	1.15	1.25
0.1094	2.779	0.0310	0.787	311	110	67	80	J	8	0.0394	1.000	0.27	0.33	0.32	0.40
0.1094	2.779	0.0310	0.787	284	96	67	80	W	7	0.0394	1.000	0.27	0.33	0.40	0.48
0.1406	3.571	0.0310	0.787	558	180	60	67	W,J	6	0.0625	1.588	0.50	0.57	0.74	0.84
0.1406	3.571	0.0310	0.787	640	227	53	63	J	7	0.0625	1.588	0.96	1.05	1.23	1.35
0.1562	3.967	0.0300	0.762	631	219	56	67	J	7	0.0625	1.588	1.04	1.20	1.37	1.53
0.1719	4.366	—	—	640	227	53	63	J	7	0.0625	1.588	3.30	—	3.30	—
0.1250	3.175	0.0360	0.914	359	150	53	63	W	10	0.0394	1.000	0.51	0.58	0.61	0.72
0.1250	3.175	0.0360	0.914	359	150	53	63	W	10	0.0394	1.000	0.40	0.47	0.45	0.56
0.1250	3.175	0.0310	0.787	709	272	50	60	J	8	0.0625	1.588	0.81	0.90	0.85	0.97
—	—	—	—	1301	488	43	53	J	7	0.0937	2.381	—	2.50	—	—
0.1960	4.978	0.0420	1.067	1301	488	43	53	J	7	0.0937	2.381	2.21	—	2.95	3.24
0.1960	4.978	—	—	1480	621	38	45	J	8	0.0937	2.381	4.75	—	5.08	—
0.1250	3.175	0.0360	0.914	373	172	48	56	W	11	0.0394	1.000	0.57	0.66	0.60	0.73
0.1875	4.762	0.0450	1.143	1082	442	40	50	J	8	0.0787	2.000	1.60	1.71	2.32	2.54
0.1960	4.978	0.0633	1.607	1480	621	38	45	J	8	0.0937	2.381	4.46	4.82	4.54	4.90
0.2612	7.142	—	—	2336	896	36	43	J	6	0.1378	3.500	7.48	—	10.0	—
0.1562	3.967	0.0310	0.787	542	276	40	48	W	12	0.0472	1.200	1.39	1.54	1.57	1.72
0.2512	7.142	0.0620	1.575	3332	1411	32	38	J	7	0.1563	3.969	9.02	9.71	11.7	12.4
0.3125	7.938	0.0620	1.575	5108	2413	27	32	J	8	0.1875	4.762	11.6	13.0	24.1	25.6
0.3438	8.733	0.0667	1.745	5999	3265	21	25	RJ	10	0.1875	4.762	23.5	—	38.1	40.40
0.4375	11.113	—	—	9384	5057	17	21	RJ,TW	9	0.2500	6.350	53.1	—	69.3	—

Bore Diameter: d	Outer Diameter: D	Flange Diameter: Df	Radius r1(min)	Open Bearings				Seal, Shield Bearings										
				Width: B		Flange Width: Bf		Open	Flange Open	Shield	Flange Shield	Seal						
				inch	mm	inch	mm						2RS	2RU	TTS			
0.0400	1.016	0.1250	3.175	0.1710	4.343	0.0039	0.10	0.0469	1.191	0.0130	0.330	R09	—	FR09	—	—	—	—
0.0469	1.191	0.1562	3.967	0.2030	5.156	0.0039	0.10	0.0625	1.588	0.0130	0.330	R0*	FR0*	R0ZZ*	FR0ZZ*	—	—	—
0.0550	1.397	0.1875	4.762	0.2340	5.944	0.0039	0.10	0.0781	1.984	0.0230	0.584	R1*	FR1*	R1ZZ*	FR1ZZ*	—	—	—
0.0781	1.984	0.2500	6.350	0.2960	7.518	0.0039	0.10	0.0937	2.380	0.0230	0.584	R1-4*	FR1-4*	R1-4ZZ*	FR1-4ZZ*	—	—	TTS
0.0937	2.380	0.1875	4.762	0.2340	5.944	0.0039	0.10	0.0625	1.588	0.0180	0.457	R133	FR133	—	—	—	—	—
—	—	0.1875	4.762	0.2340	5.944	0.0039	0.10	—	—	—	—	—	—	R133ZZS*	FR133ZZS*	—	—	—
—	—	0.3125	7.938	0.3590	9.119	0.0059	0.15	0.1094	2.779	0.0230	0.584	R1-5*	FR1-5*	R1-5ZZS*	FR1-5ZZS*	—	—	TTS
0.1250	3.175	0.2500	6.350	0.2960	7.518	0.0039	0.10	0.0937	2.380	0.0230	0.584	R144J*	FR144J*	R144ZZ*	FR144ZZ*	—	—	TTS
—	—	0.2500	6.350	0.2960	7.518	0.0039	0.10	0.0937	2.380	0.0230	0.584	R144*	FR144*	R144ZZ*	FR144ZZ*	—	—	TTS
—	—	0.3125	7.938	0.3590	9.119	0.0039	0.10	0.1094	2.779	0.0230	0.584	R2-5*	FR2-5*	R2-5ZZ*	FR2-5ZZ*	—	—	TTS
—	—	0.3750	9.525	0.4220	10.719	0.0059	0.15	0.1094	2.779	0.0230	0.584	R2-6*	FR2-6*	R2-6ZZ*	FR2-6ZZ*	2RS	2RU	TTS
—	—	0.3750	9.525	0.4400	11.176	0.0118	0.30	0.1562	3.967	0.0300	0.762	R2*	FR2*	R2ZZ*	FR2ZZ*	2RS	2RU	—
—	—	0.5000	12.700	—	—	0.0118	0.30	0.1719	4.366	—	—	R2A	—	R2AZZ	—	—	—	—
0.1562	3.967	0.3125	7.938	0.3590	9.119	0.0039	0.10	0.1094	2.779	0.0230	0.584	R155*	FR155*	R155ZZS*	FR155ZZS*	—	—	—
0.1875	4.762	0.3125	7.938	0.3590	9.119	0.0039	0.10	0.1094	2.779	0.0230	0.584	R156*	FR156*	R156ZZS*	FR156ZZS*	—	—	TTS
—	—	0.3750	9.525	0.4220	10.719	0.0039	0.10	0.1250	3.175	0.0230	0.584	R166*	FR166*	R166ZZ*	FR166ZZ*	—	—	TTS
—	—	0.5000	12.700	0.5650	14.351	0.0118	0.30	0.1960	4.978	0.0420	1.067	—	FR3*	—	—	—	—	—
—	—	0.5000	12.700	0.5650	14.351	0.0118	0.30	0.1562	3.967	—	—	R3*	—	R3ZZ*	FR3ZZ*	2RS	2RU	TTS
—	—	0.6250	15.875	—	—	0.0118	0.30	0.1960	4.978	—	—	R3A	—	R3AZZ	—	2RS	2RU	—
0.2500	6.350	0.3750	9.525	0.4220	10.719	0.0039	0.10	0.1250	3.175	0.0230	0.584	R168*	FR168*	R168ZZS*	FR168ZZS*	—	—	TTS
—	—	0.5000	12.700	0.5470	13.894	0.0059	0.15	0.1250	3.175	0.0230	0.584	R188*	FR188*	R188ZZ*	FR188ZZ*	2RS	2RU	TTS
—	—	0.6250	15.875	0.6900	17.526	0.0118	0.30	0.1960	4.978	0.0420	1.067	R4*	FR4*	R4ZZ*	FR4ZZ*	2RS	2RU	TTS
—	—	0.7500	19.050	—	—	0.0157	0.40	0.2188	5.558	—	—	R4A	—	R4AZZ	—	2RS	2RU	—
0.3125	7.938	0.5000	12.700	0.5470	13.894	0.0059	0.15	0.1562	3.967	0.0310	0.787	R1810*	FR1810*	R1810ZZS	FR1810ZZS*	—	—	TTS
0.3750	9.525	0.8750	22.225	0.9690	24.613	0.0157	0.40	0.2188	5.558	0.0620	1.575	R6	FR6*	R6ZZ	FR6ZZ*	2RS	2RU	TTS
0.5000	12.700	1.1250	28.575	1.2252	31.120	0.0157	0.40	0.2500	6.350	0.0620	1.575	R8	FR8*	R8ZZ	FR8ZZ*	2RS	2RU	TTS
0.6250	15.875	1.3750	34.925	1.4900	37.846	0.0315	0.80	0.2812	7.142	—	—	R10	—	R10ZZ	FR10ZZ	2RS	2RU	—
0.7500	19.050	1.6250	41.275	—	—	0.0315	0.80	0.3125	7.938	—	—	R12	—	R12ZZ	—	2RS	2RU	—

1) *Available with inner ring width extended by 0.015"(0.3962mm) each side.
 2) Bearings also available with single shield or seal : suffix Z, RS, RU or TS
 3) Bearings also available with stainless material : suffix S or H